

Siderise RH & RV installation

Cladding cavity barriers – allows for drainage and ventilation

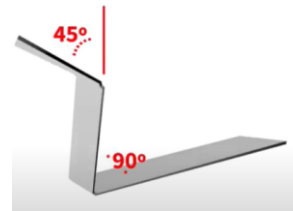

Watch the video of You Tube

- <https://www.youtube.com/watch?v=E4fc2OnulD8>
- For more test reports information visit:
 - www.tfire.com.au
 - <https://tfire.com.au/catalogue/cat/Siderise-for-Cladding>

Vertical barriers installation.

Vertical barriers must be installed first.

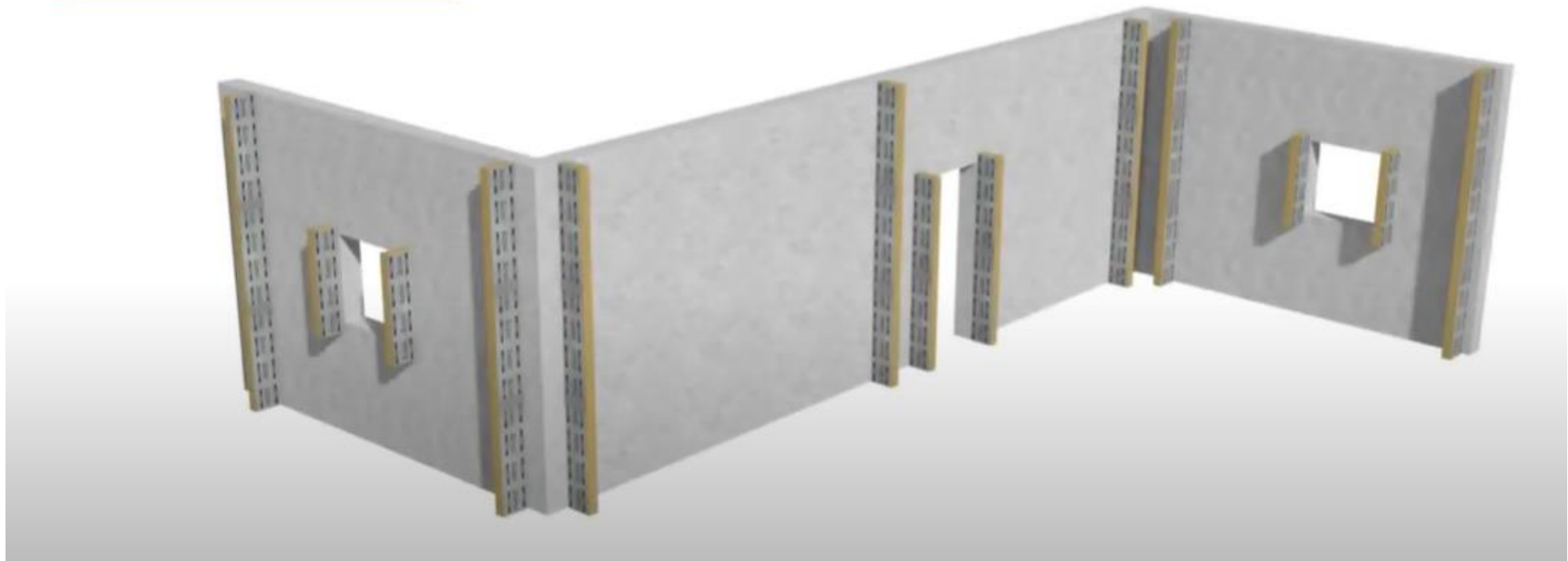

Easy to identify and clean fire & smoke seal

Siderise CW-FS is made via a unique manufacturing process from pre-compressed stonewool lamella strips and foil facings.

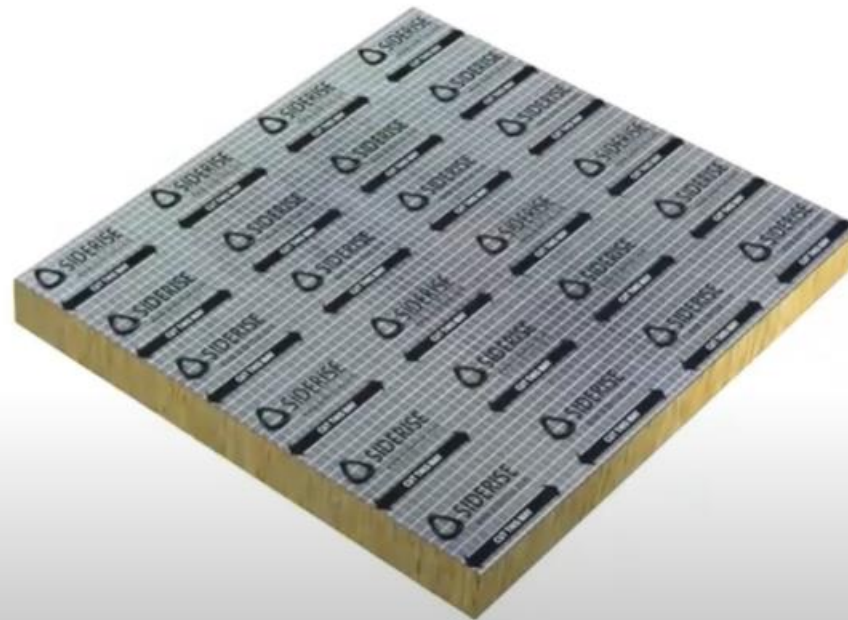



CW-FS is supplied as pre-cut strips that suit the measured void size.

Or as a single sheet for cutting on site.

Engineered fibre orientation

Cut in the direction that is marked
on the foil facing.



SIDERISE

www.siderise.com



Vertical barriers - Installing brackets.

Bracket fixing options:

RV can be installed in 2 main ways

- 1 Setting the brackets on wall, then inserting the RV barrier.

Vertical barriers - Installing brackets.

Set brackets at 600mm centres.

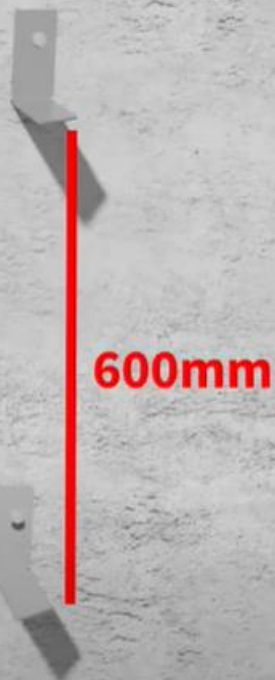

Siderise RHV vertical cavity barrier – 1200mm long

Vertical barriers - Installing brackets.

Make 2 vertical incisions in the reverse of the barrier with a sharp knife.

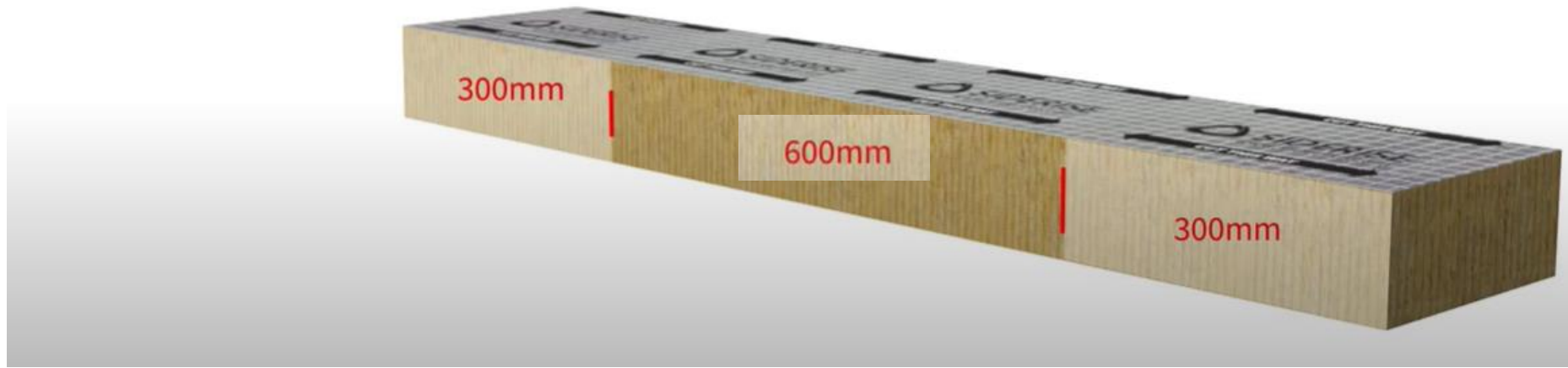

Vertical barriers - Installing brackets.

Press barrier onto brackets ensuring it is tightly abutted to the barrier below and above.

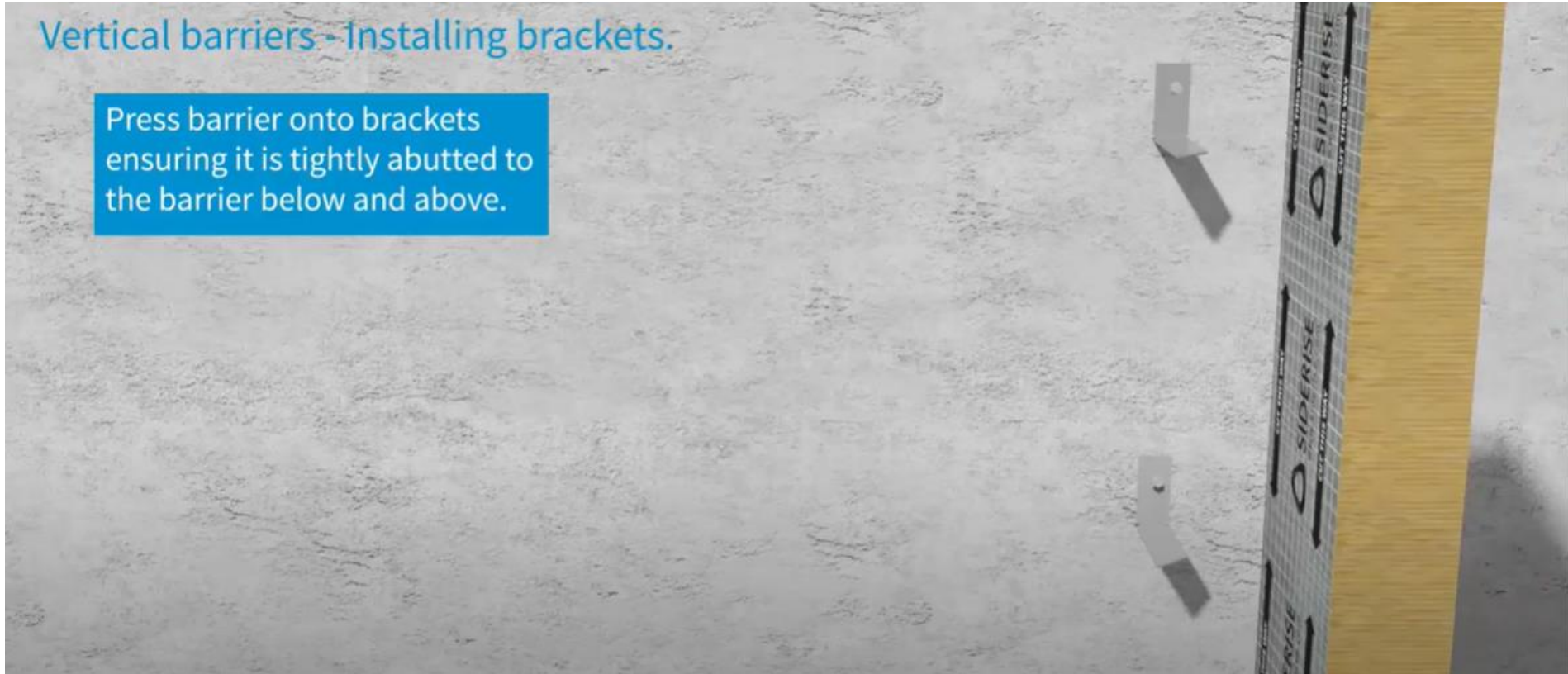

Vertical barriers - Installing brackets.

Press barrier onto brackets ensuring it is tightly abutted to the barrier below and above.

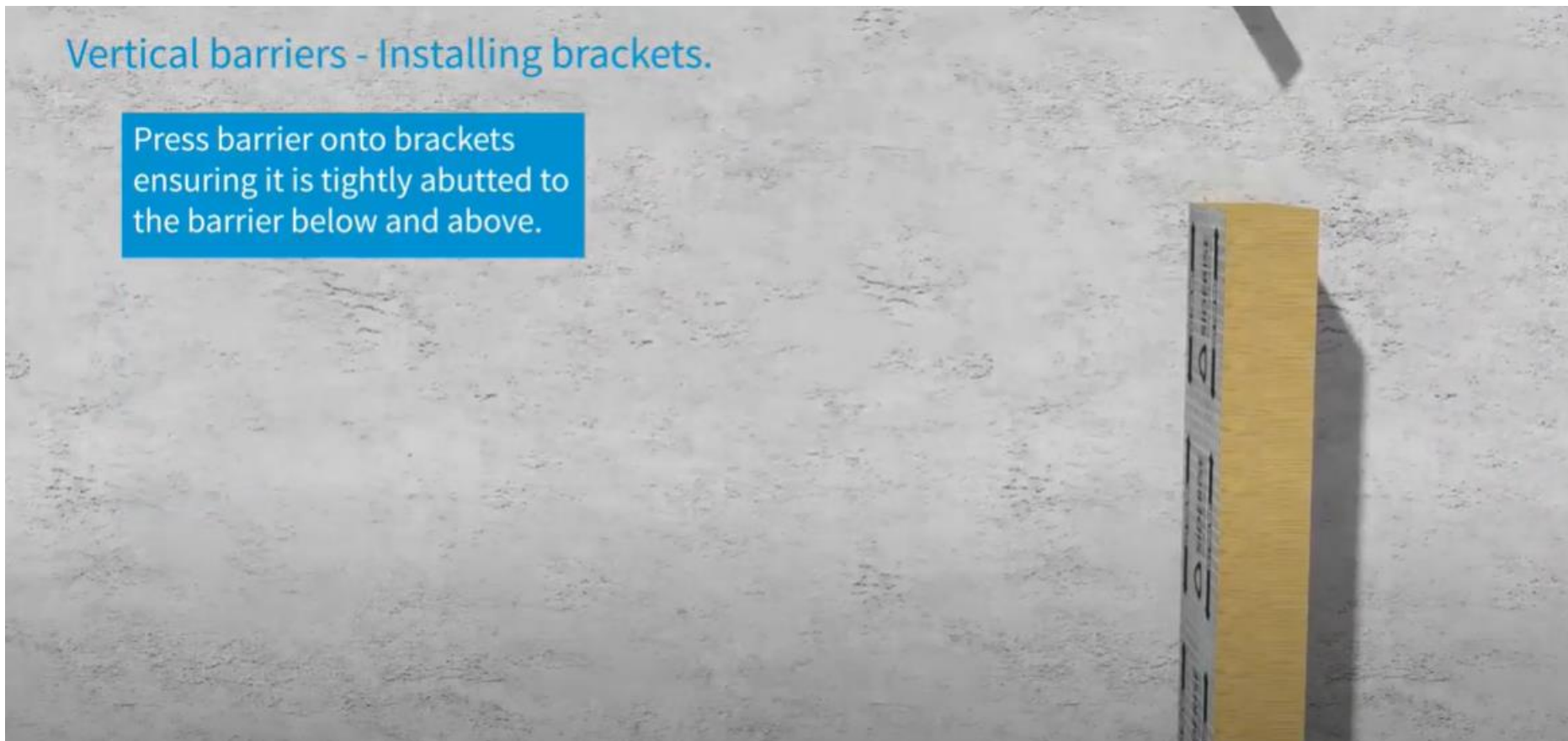

Add subsequent pieces

Vertical barriers - Installing brackets.

Press barrier onto brackets ensuring it is tightly abutted to the barrier below and above.



Vertical barriers - Installing brackets.

Bracket fixing options:

RV can be installed in 2 main ways

- 1 Setting the brackets on wall, then inserting the RV barrier.
- 2 Inserting the brackets into the RV barrier first, then fixing the barrier to the wall.

Vertical barriers - Installing brackets.

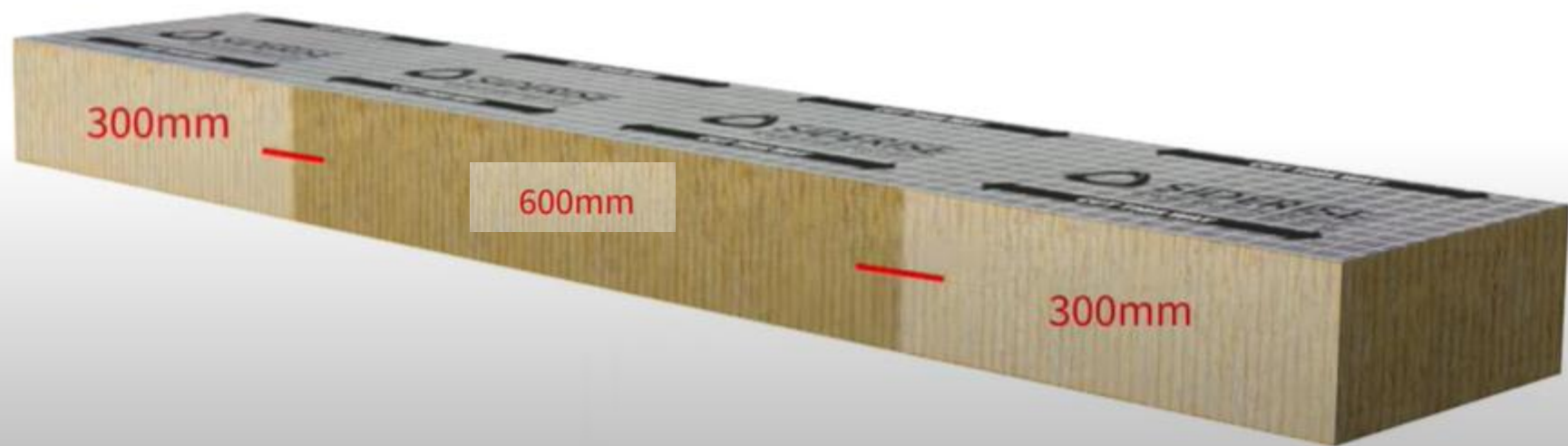

Vertical barriers - Installing brackets.

Insert the brackets into the RV barrier.



Vertical barriers - Installing brackets.

Insert the brackets into the RV barrier.

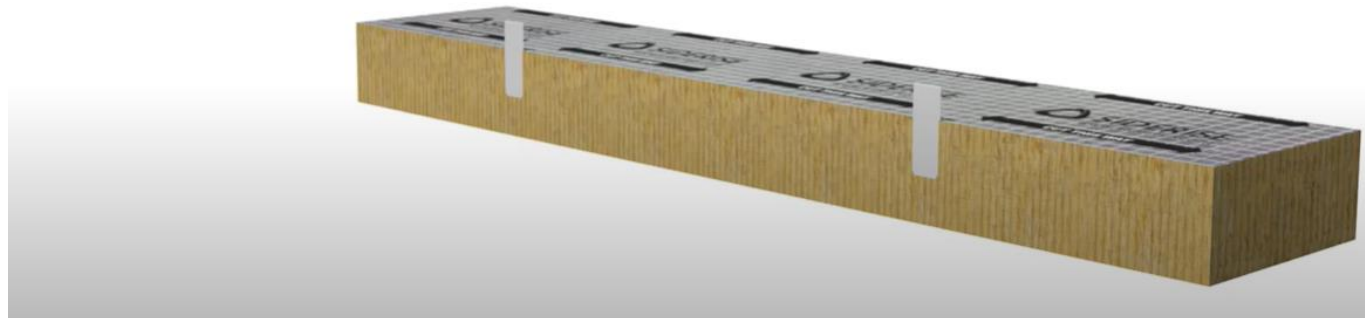

Vertical barriers - Installing brackets.

Insert the brackets into the RV barrier.

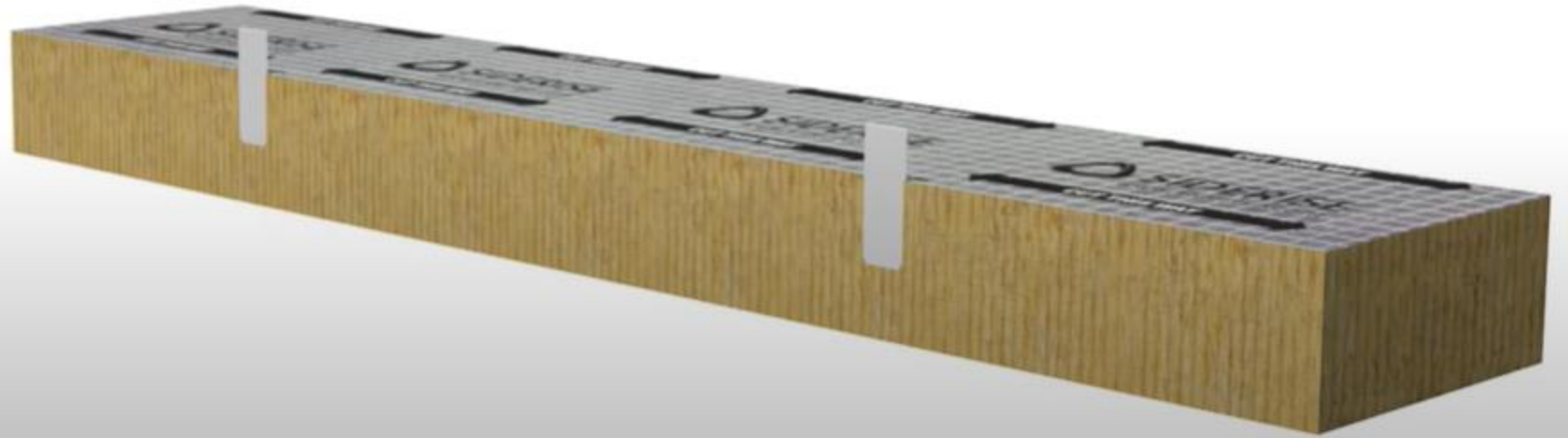

Vertical barriers - Installing brackets.

Hold the barrier against the wall.

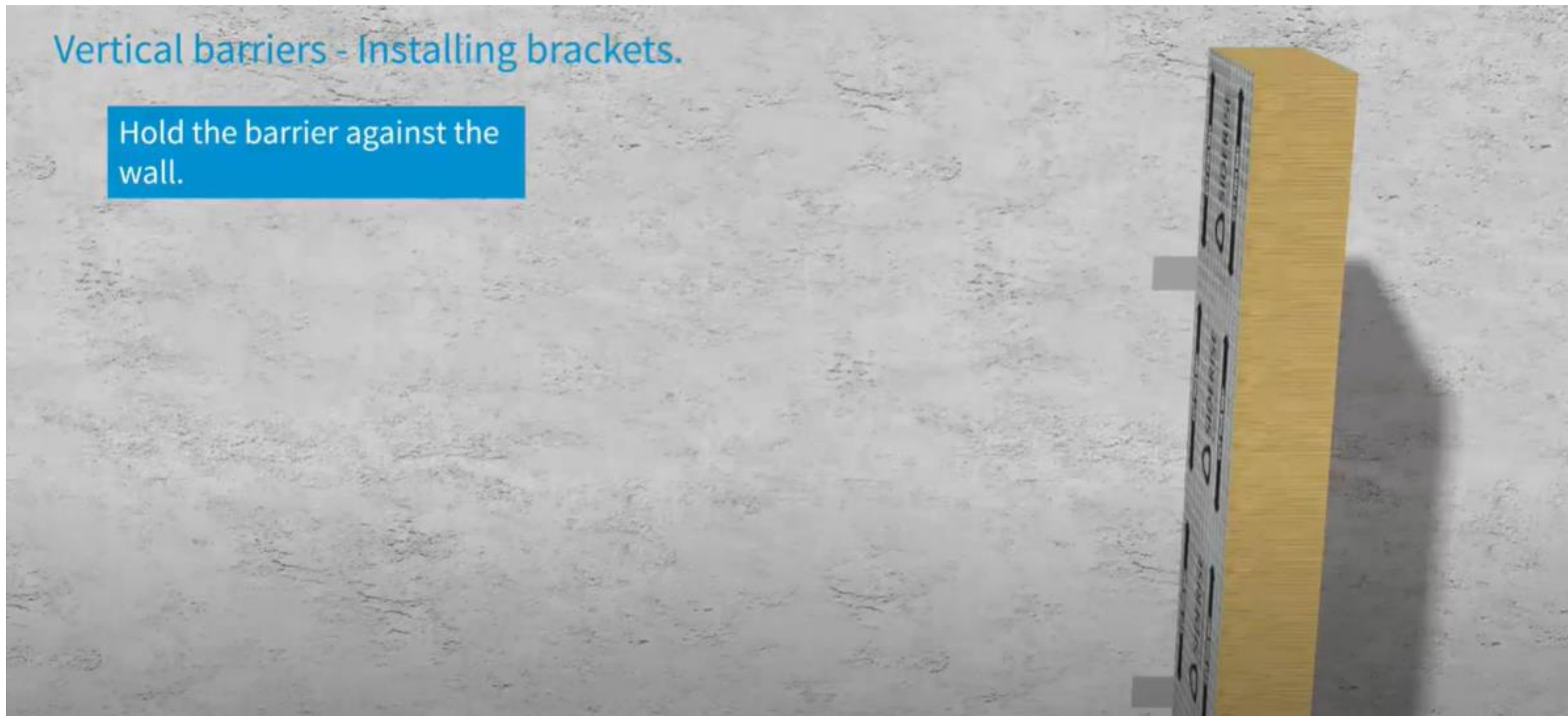

Vertical barriers - Installing brackets.

Mechanically fix the brackets to the wall, ensuring the barrier is tightly abutted to the barrier below and above.

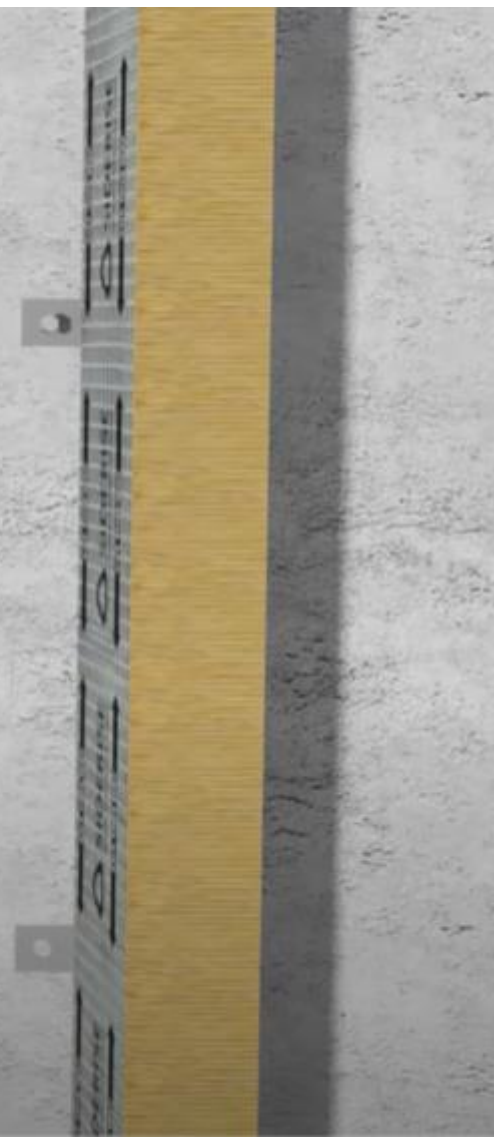
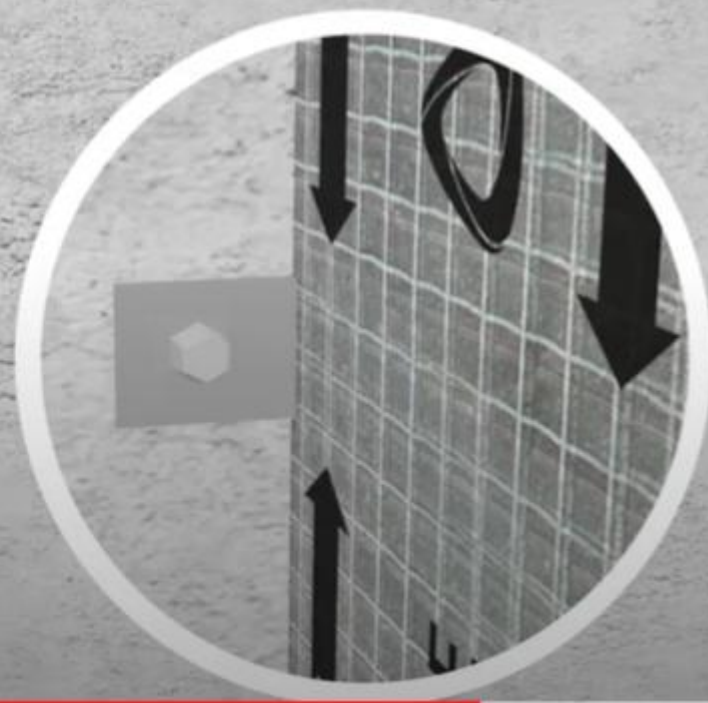

Seal butt joints with tape for smoke seal



RH strip only available for re-cladding



‘Open state’ Horizontal barriers installation.

RH horizontal cavity barriers are supplied 1200mm long.

RH25 are suitable for 25mm air gaps.

RH50 are suitable for 50mm air gaps.

TOP	 SIDERISE.com	 RH 25	OPEN STATE CAVITY BARRIER	MAX  25mm AIR GAP $\pm 3.0\text{mm}$	 E90 I30 EI30
TOP	 SIDERISE.com	 RH 25	OPEN STATE CAVITY BARRIER	MAX  25mm AIR GAP $\pm 3.0\text{mm}$	 E60 I60 EI60
TOP	 SIDERISE.com	 RH 25	OPEN STATE CAVITY BARRIER	MAX  25mm AIR GAP $\pm 3.0\text{mm}$	 E90 I60 EI60
TOP	 SIDERISE.com	 RH 25	OPEN STATE CAVITY BARRIER	MAX  25mm AIR GAP $\pm 3.0\text{mm}$	 E120 I60 EI60
TOP	 SIDERISE.com	 RH 25	OPEN STATE CAVITY BARRIER	MAX  25mm AIR GAP $\pm 3.0\text{mm}$	 E120 I90 EI90
TOP	 SIDERISE.com	 RH 50	OPEN STATE CAVITY BARRIER	MAX  50mm AIR GAP $\pm 3.0\text{mm}$	 E30 I30 EI30
TOP	 SIDERISE.com	 RH 50	OPEN STATE CAVITY BARRIER	MAX  50mm AIR GAP $\pm 3.0\text{mm}$	 E60 I60 EI60

‘Open state’ Horizontal barriers installation.

Product is ordered to suit project requirements.

When ordering, order product to suit site tolerances.



‘Open state’ Horizontal barriers installation.

Product is ordered to suit project requirements.

When ordering, order product to suit site tolerances.

Product can be trimmed on site along the back edge to suit required site dimensions.

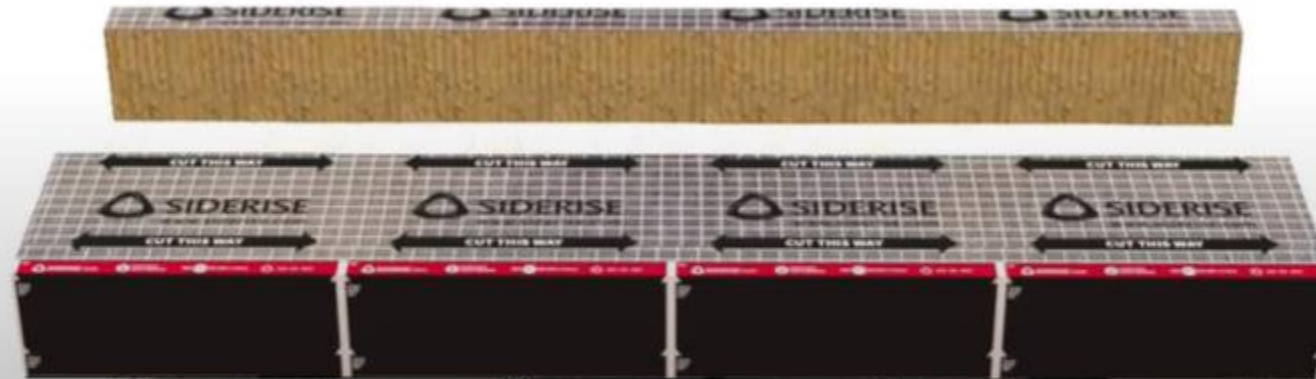

Simple mounting brackets

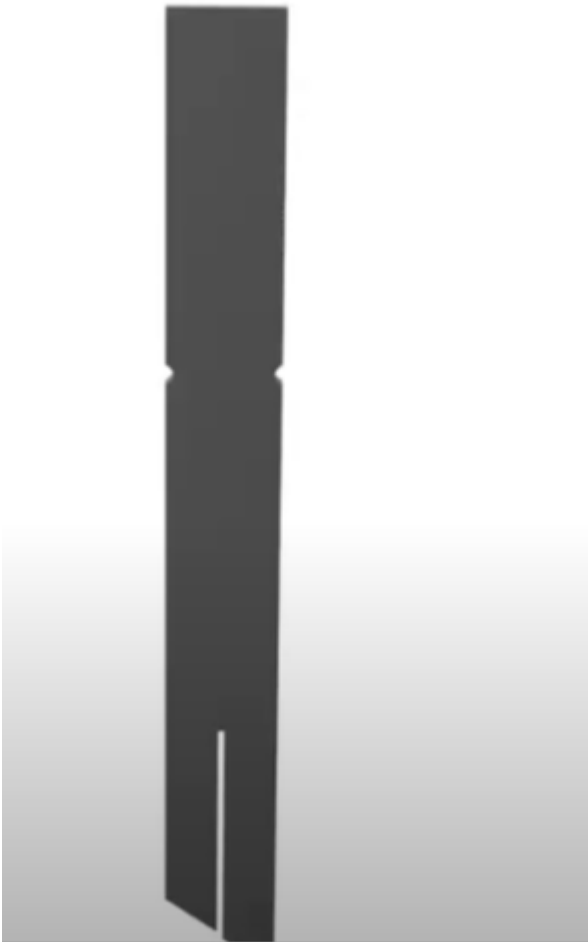

‘Open state’ Horizontal barriers installation.

3 brackets are needed for each
RH barrier.

Manually fold brackets to 90°.



‘Open state’ Horizontal barriers installation.

Slit the barrier with 3 horizontal incisions at 400mm centres where 3 brackets will be inserted. This will make it easier to push the bracket through the RH barrier’s intumescent layer.

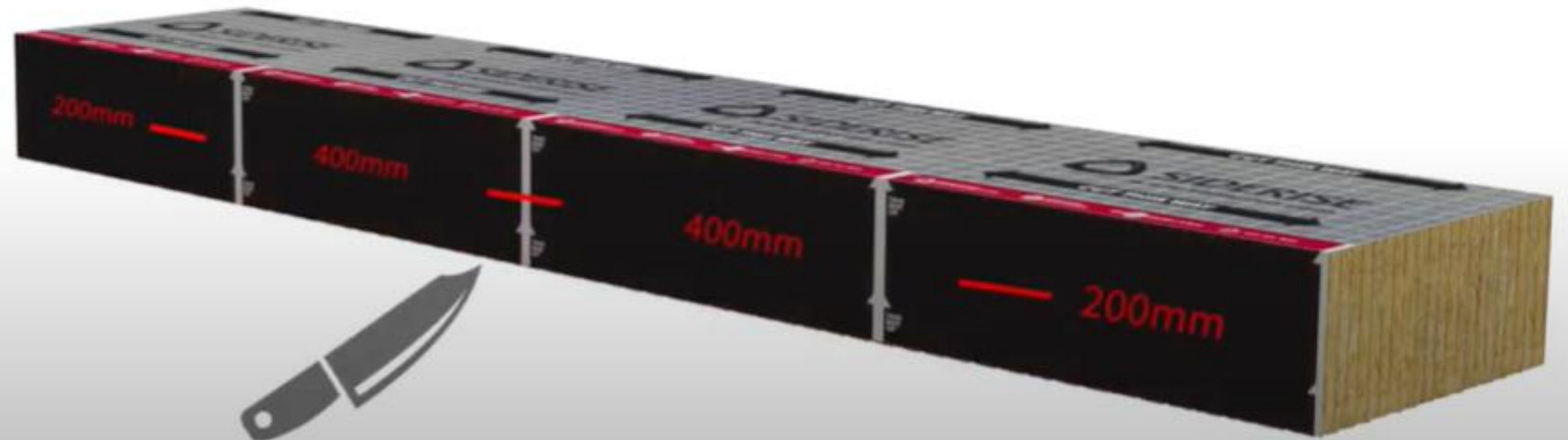

Prepare other side of RH cavity barrier strip

‘Open state’ Horizontal barriers installation.

With a sharp knife make 3 horizontal incisions in the reverse of the barrier at 400mm centres so that they are aligned with the slits made on the front face.

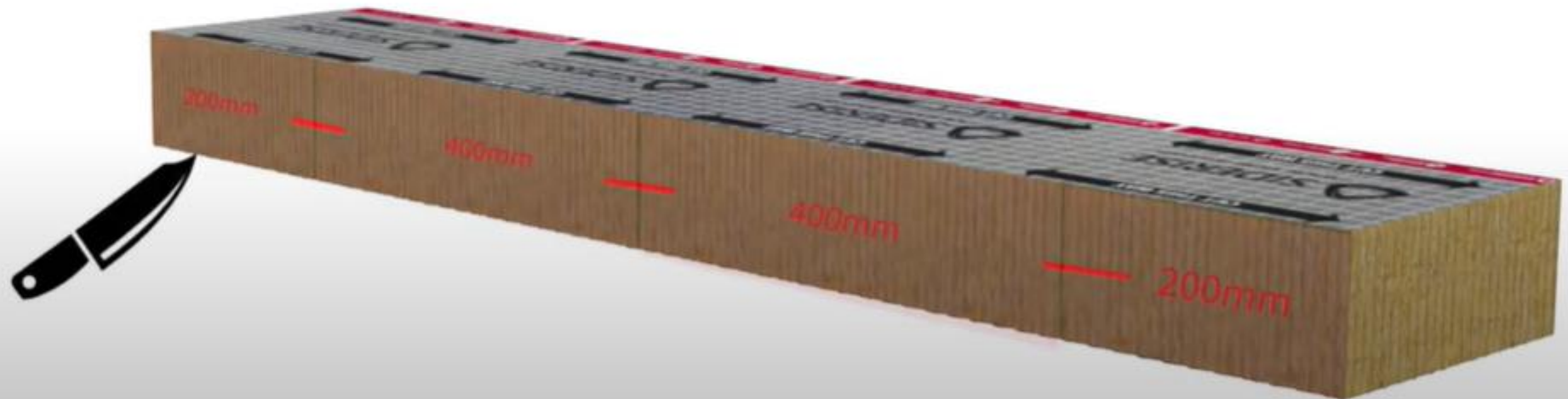

'Open state' Horizontal barriers installation.

Insert the brackets into the RH barrier.

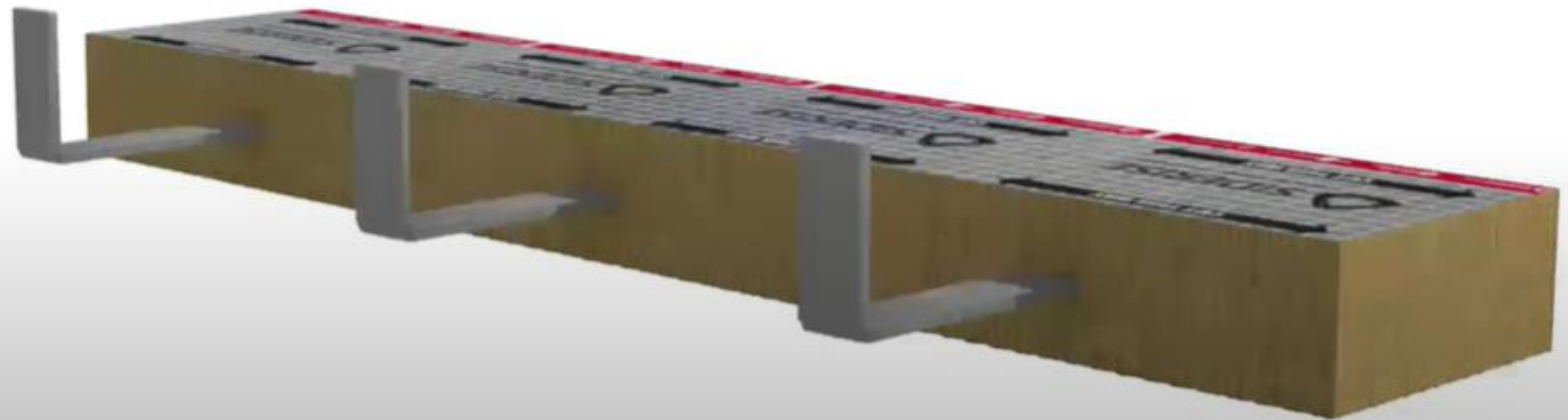

'Open state' Horizontal barriers installation.

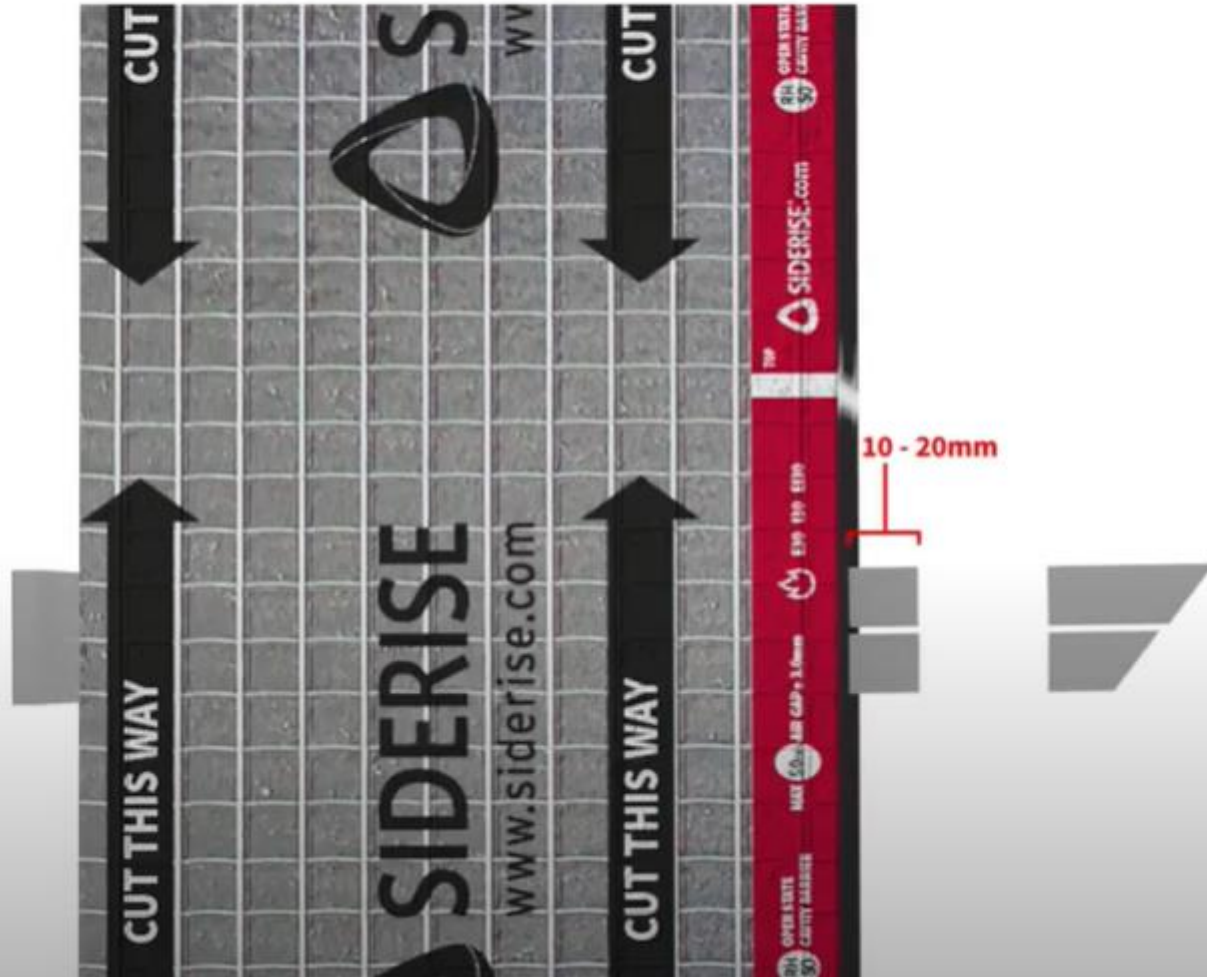

The end of the brackets must be trimmed to 10 - 20mm.

Bend over tabs to secure bracket to RH cavity barrier to mechanically hold intumescent

'Open state' Horizontal barriers installation.

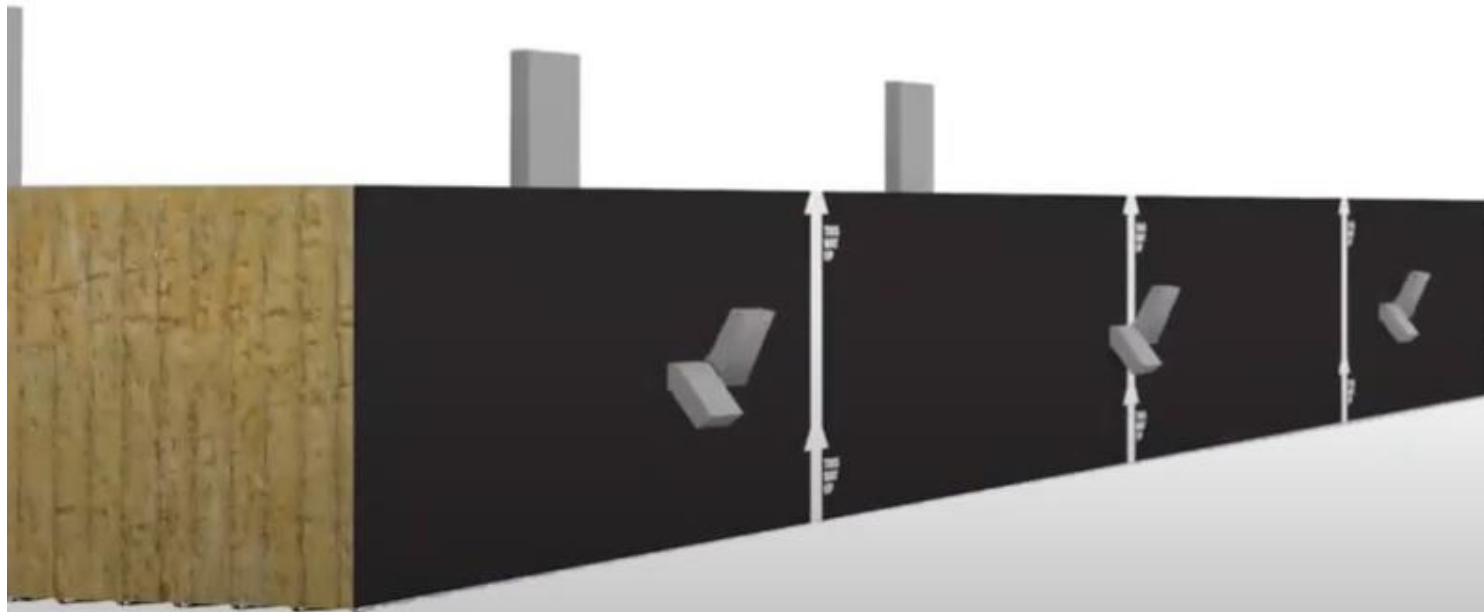

Fold the split end of the bracket half upwards and half downwards using the pliers.

'Open state' Horizontal barriers installation.

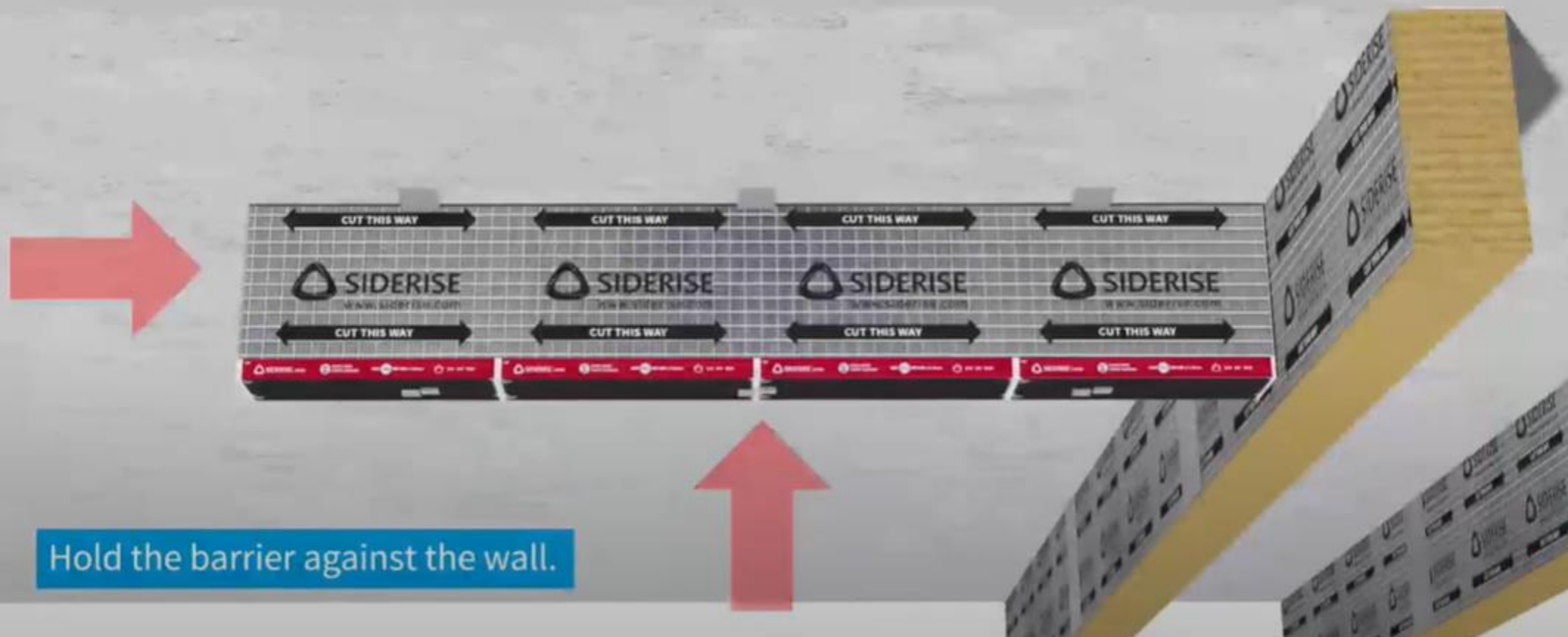

Ensure correct drainage and air gap to where cladding will go – example 25mm



'Open state' Horizontal barriers installation.



Mechanically fix the brackets to the wall, ensuring the barrier is tightly abutted to the barriers next to it.

Seal joints with foil tape.

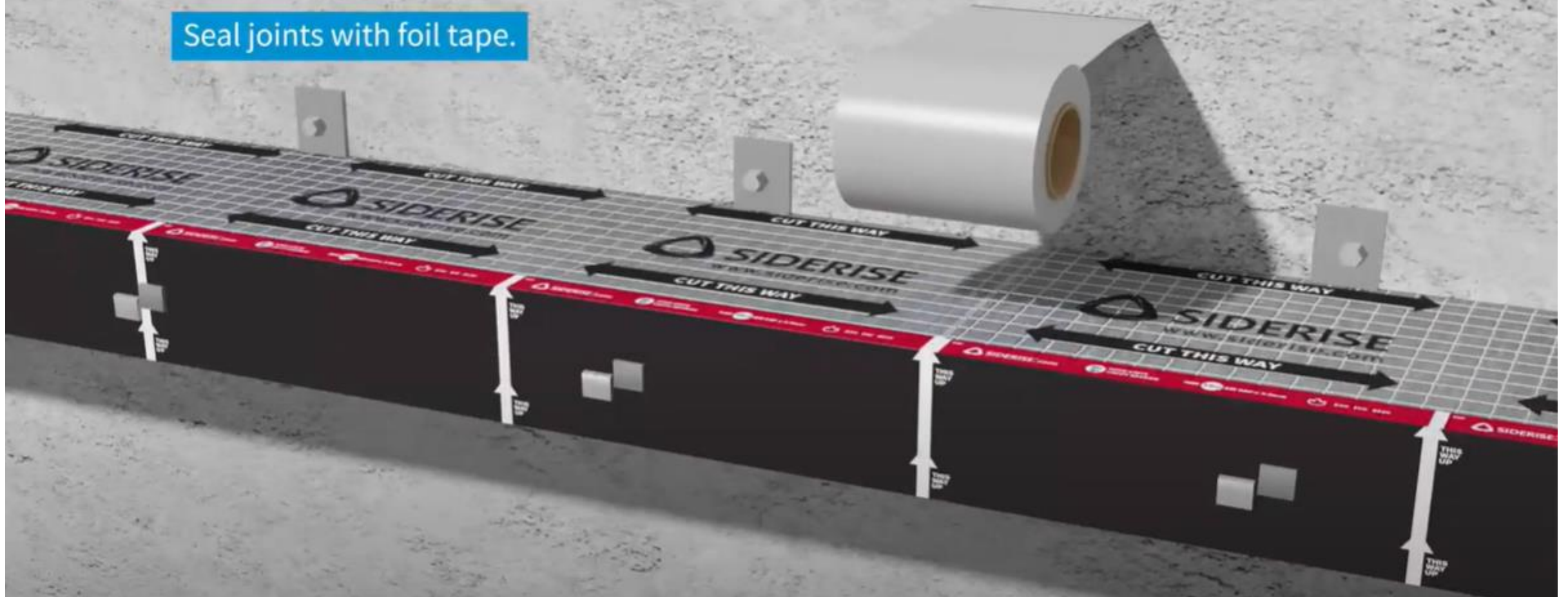

'Open state' Horizontal barriers installation.

Where RV and RH barriers meet ensure that they are tightly abutted.

Seal joints with foil tape.

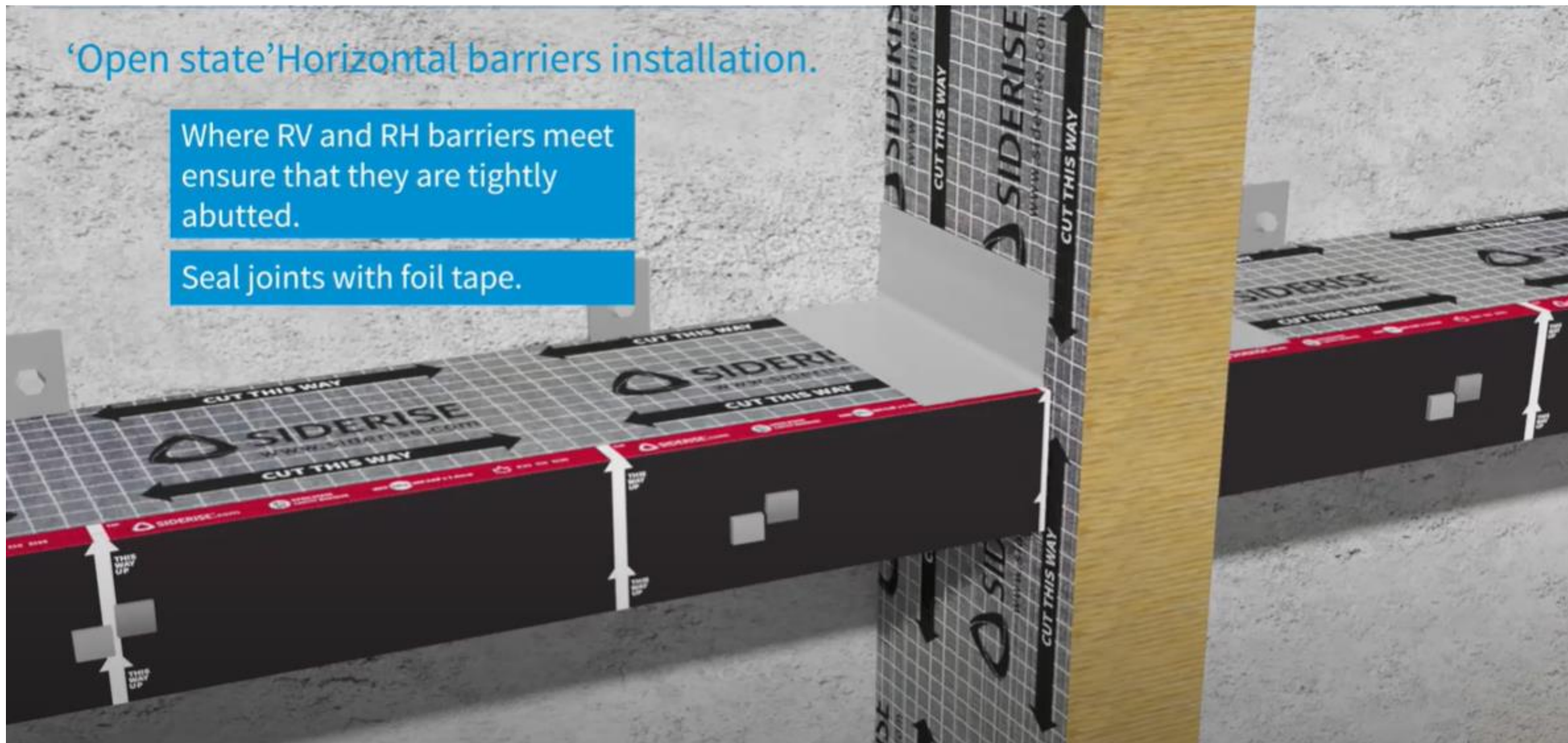

External corners

Carefully cut barrier to ensure mitred edges are tightly abutted and ensuring continuity of intumescent on leading edge.

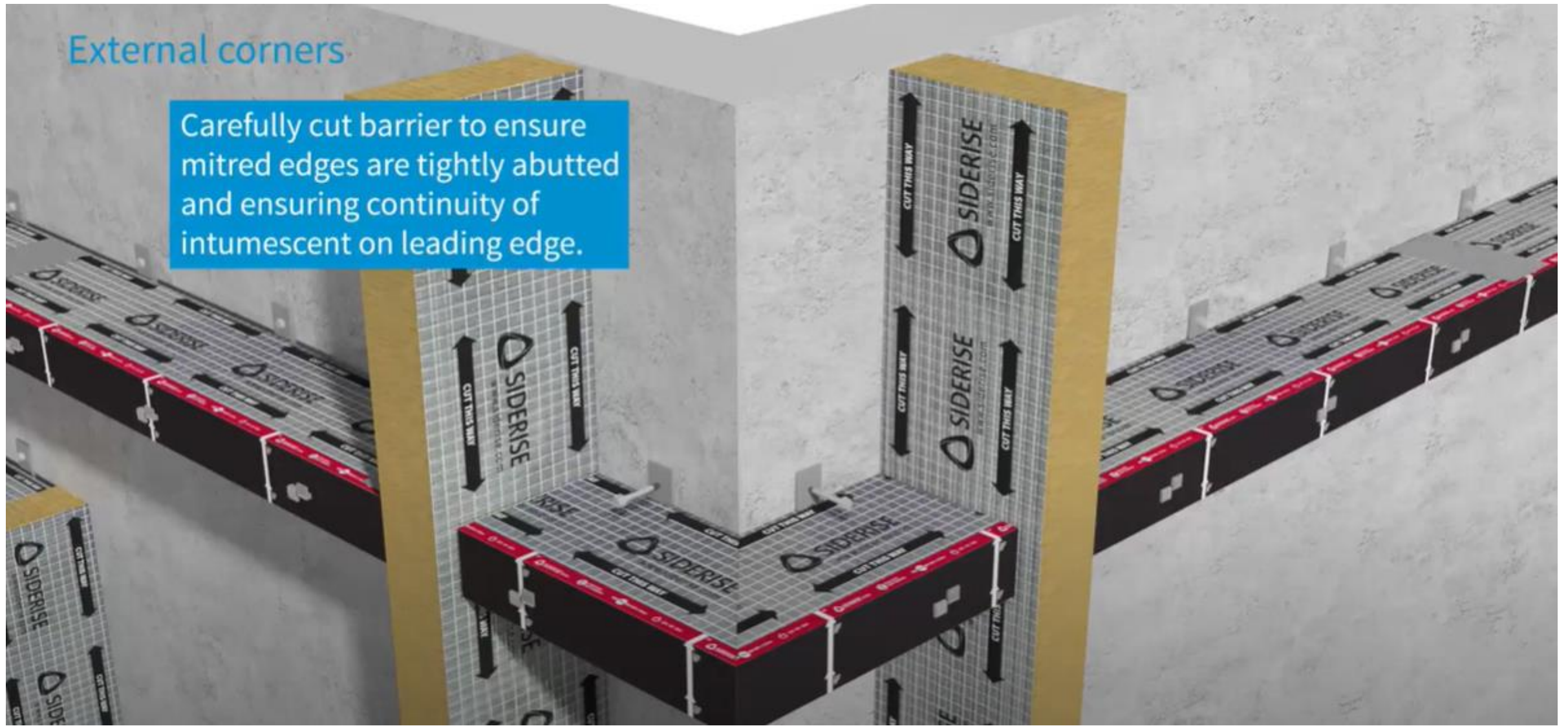

Internal corners

Carefully cut barrier to ensure mitred edges are tightly abutted and ensuring continuity of intumescent on leading edge.

Tape joints.

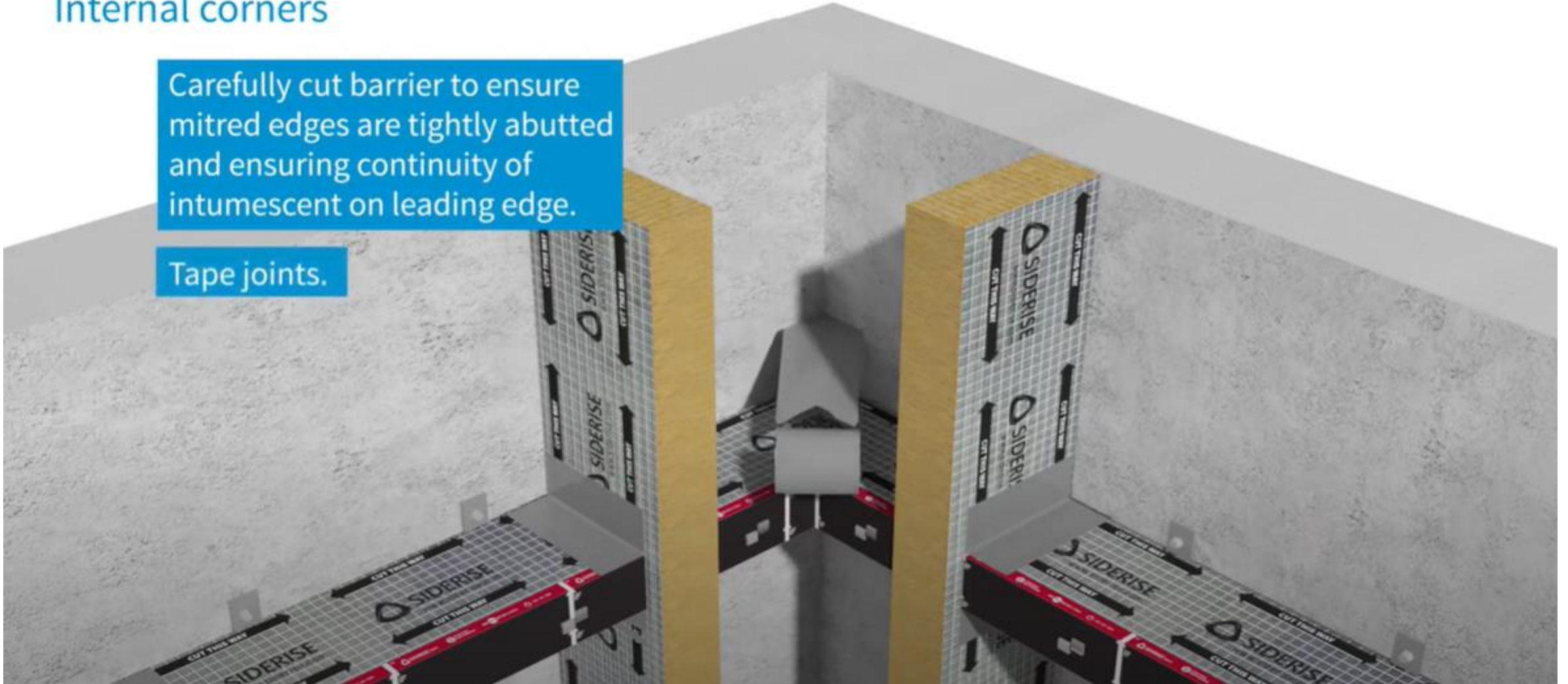

Doors and Windows.

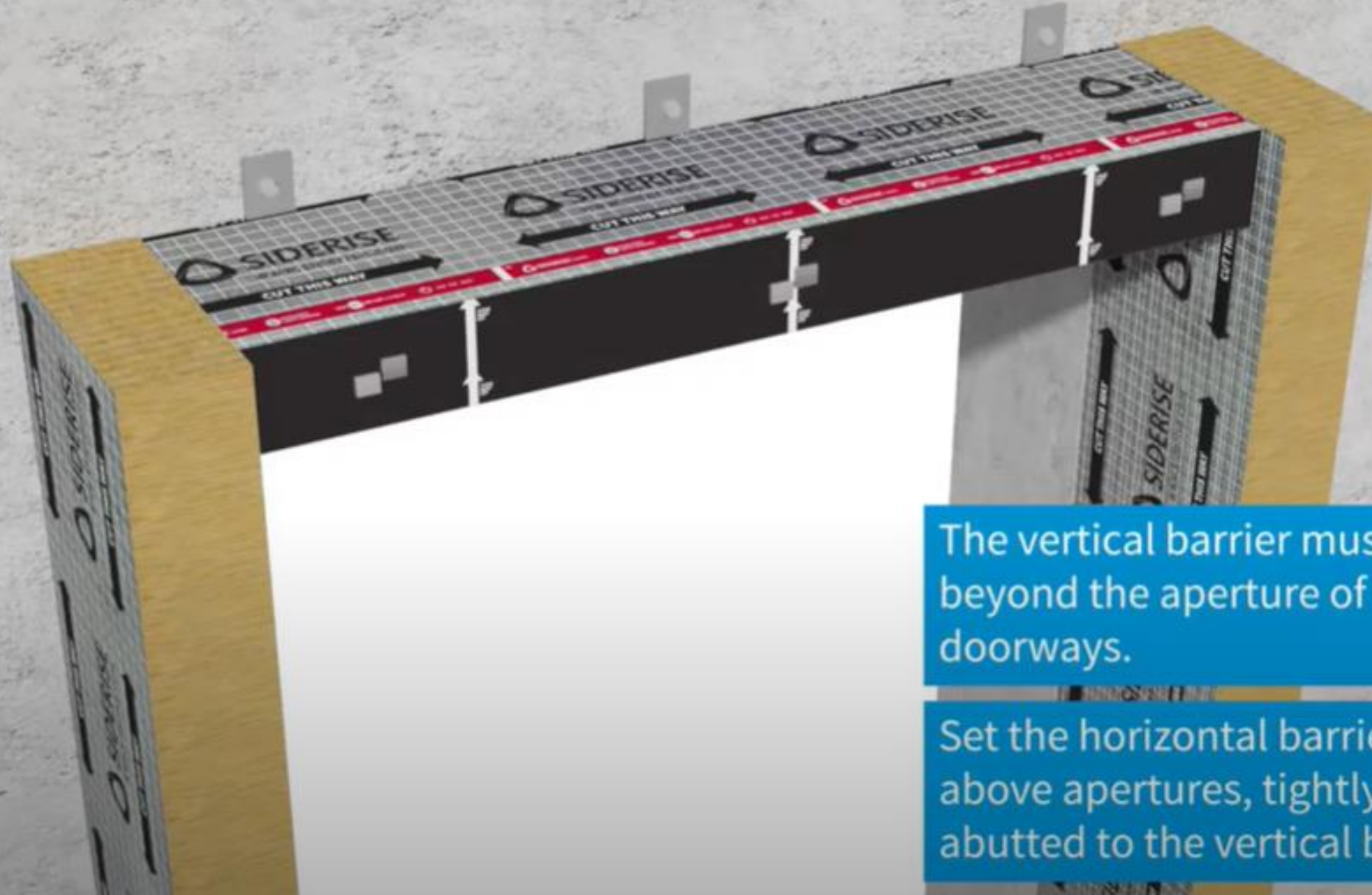

The vertical barrier must extend beyond the aperture of doorways.

Set the horizontal barriers above apertures, tightly abutted to the vertical barriers.

Doors and Windows.

The vertical barriers must extend above and below the window aperture.

Set the horizontal barriers tightly abutted between the vertical barriers.

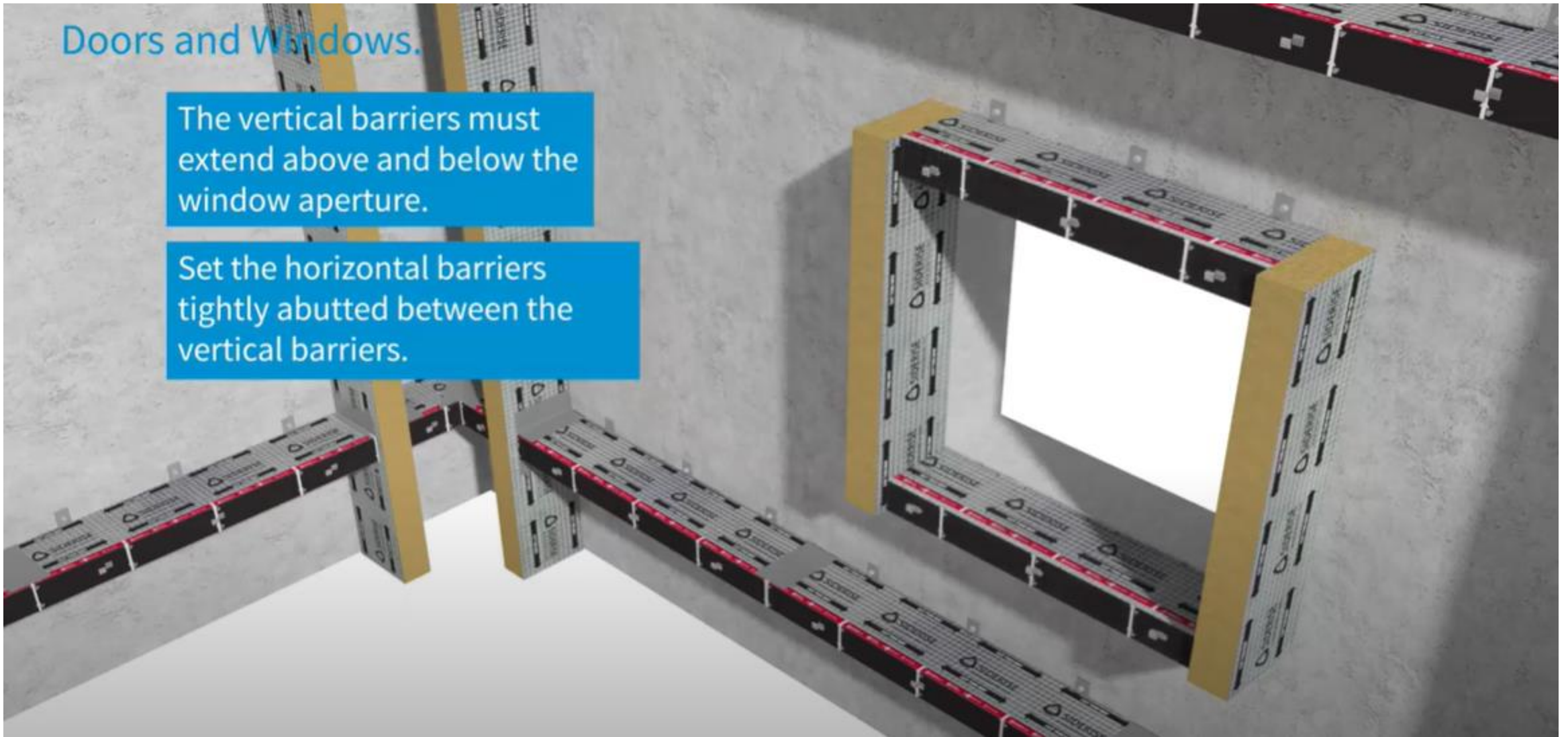

Doors and Windows.

Every internal and external joint, where vertical and horizontal barriers meet, must be sealed with foil tape.

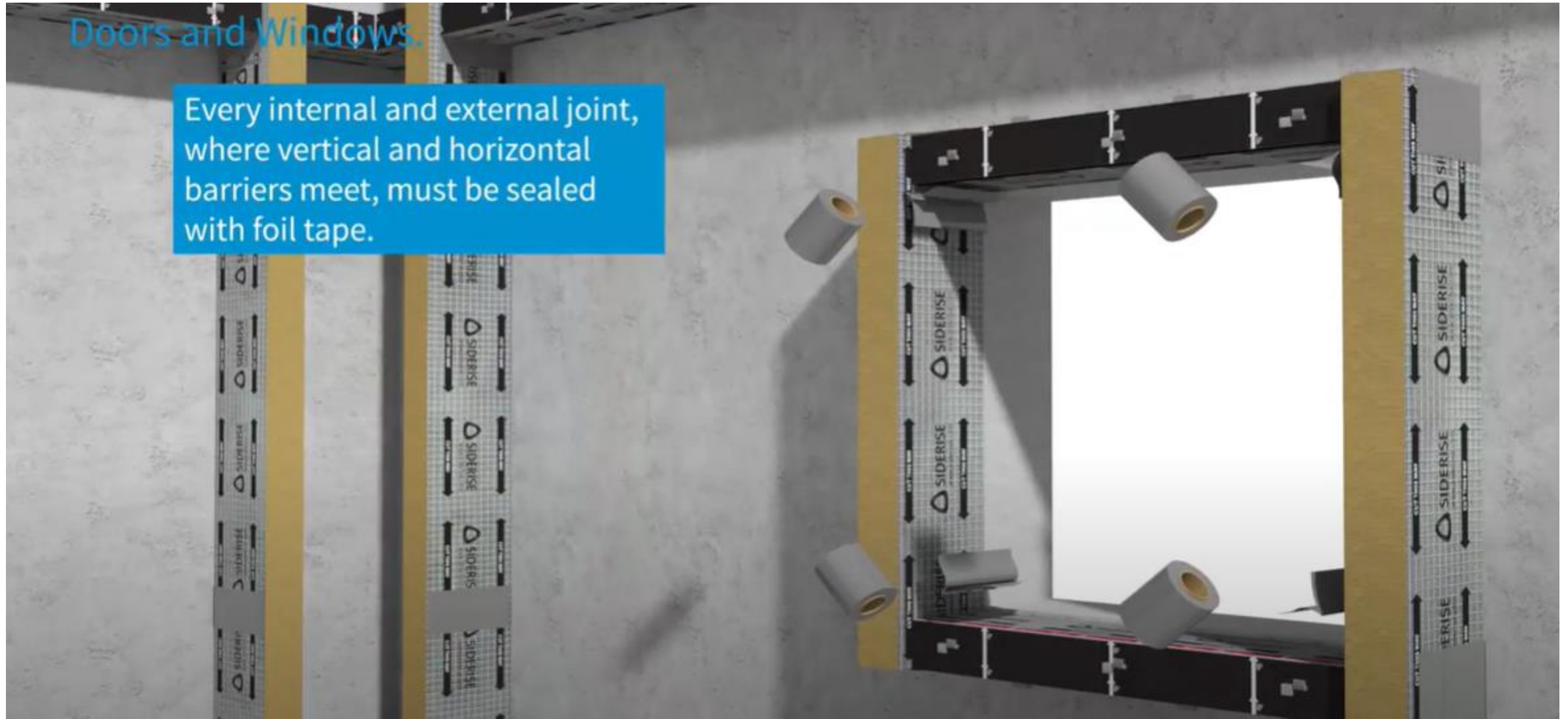

Completed cavity barriers

Vertical and open state Horizontal

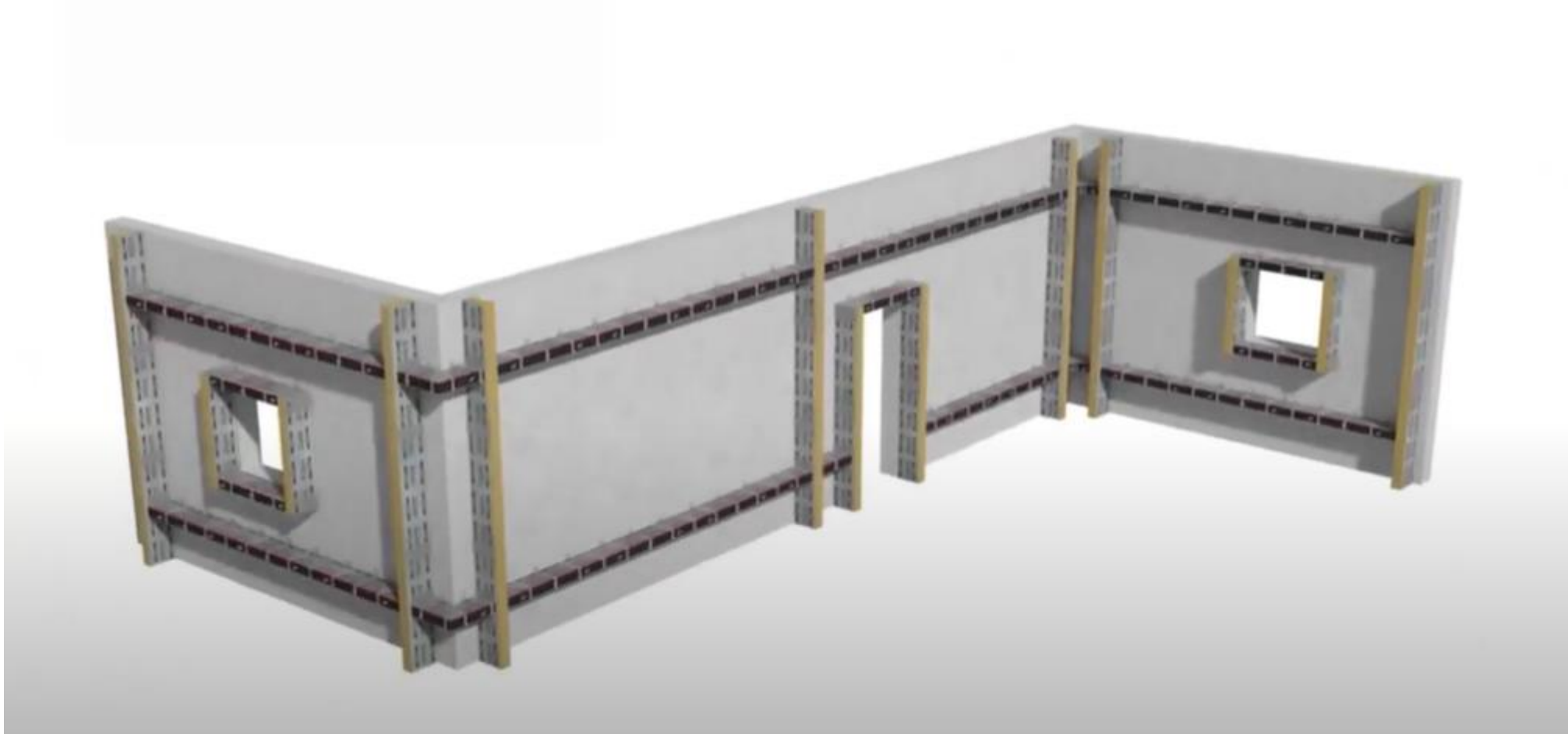

Now you can fit thermal insulation around cavity barriers



Install thermal insulation once RH and RV barriers have been installed.



FREE technical support available

- For more test reports information visit:
 - www.tfire.com.au
 - <https://tfire.com.au/catalogue/cat/Siderise-for-Cladding>
- For FREE technical design and on-site assistance contact:
 - technical@fire.com.au or phone 1800 888 714